

Commercial ice maker
MODEL:FCMIM0017



INSTRUCTION MANUAL

Read these instructions carefully before using your appliance, and keep it carefully.
If you follow the instructions, your appliance will provide you with many years of good service.

10/2024

Customer Care

Thank you for purchasing a Forno product. Please read the entire instruction manual before operating your new appliance for the first time. Whether you are an occasional user or an expert, it will be beneficial to familiarize yourself with the safety practices, features, operation and care recommendations of your appliance.

Both the model and serial number are listed inside the product. For warranty purposes, you will also need the date of purchase .

Record this information below for future reference.

Product Information

Model Number : _____

Serial Number :

Date of Purchase : _____

Purchase Address And Phone : _____

Service Information

Use these numbers in any correspondence or services calls concerning your product.

If you received a damaged product, immediately contact Forno.

To save time and money, before you call for serviced, check the troubleshooting guide. It listed the causes of minor operation problems that you can correct yourself.



"Need some quick help? Simply scan the qr code and get access to our fast support form. We're always here to assist you with any questions or concerns you may have. So, don't hesitate to reach out!"

Services in Canada and Untied States

Keep the instruction manual handy to answer your questions. If you don't understand something or need more assistance, please visit our website for fast support. Please provide us your name, number, address,serial number of the product that troubleshooting, proof of purchase, and a short description of the issue. A customer service representative will contact you as soon as possible. All warranty work needs to be authorized by FORNO customer service. All our authorized service

providers are carefully selected and rigorously trained by us.



WARNING

FOR YOUR SAFETY

Your safety and the safety of others are very important.

We have provided many important safety messages in this manual and on your appliance. Always read and obey all safety messages.



This is the safety alert symbol. This symbol alerts you to potential hazards that can kill or hurt you and others. All safety messages will follow the safety alert symbol and either the word "DANGER," "WARNING" or "CAUTION." These words mean:



DANGER

- You can be killed or seriously injured if you don't **immediately** follow instructions.



WARNING

- You can be killed or seriously injured if you don't follow instructions.



CAUTION

- A potentially hazardous situation which, if not avoided, could result in minor or moderate injury.

All safety messages will tell you what the potential hazard is, tell you how to reduce the chance of injury, and tell you what can happen if the instructions are not followed.



WARNING : This product can expose you to chemicals including [Lead, lead and lead compound, which is [are] known to the state of California to cause cancer and birth defects or other reproductive harm. For more information go to www.P65Warning.ca.gov.

Safety instructions

The safety of you and others is very important.

We provide a lot of safety information, please read again and again and follow the safety rules.

This is a safety warning sign:



All security information will follow the safety WARNING signs, and "DANGER" or "WARNING".



DANGER



WARNING

These two symbols mean:

If you do not follow the instructions, you will be injured or killed.

All the safety information will tell you about a potential crisis, how to reduce your chances of injury, and what will happen if you don't follow the instructions.

Important safety instructions

When using appliances, you should follow basic safety precautions to reduce the frequency of fires, electric shocks, and the risk of injury to people or property. So please read the instructions before using any appliance.

- Do not use ice makers or other devices with damaged lines.
- Do not use mechanical equipment or other tools to speed up the thawing process, except as recommended by the manufacturer.
- If the power cord is damaged, be sure to have it replaced by the manufacturer or service agent or an equally qualified person in case of danger. The ice machine must be set up so that it can be powered on.
- Do not put the power cord on the carpet or other insulation material, do not cover the power cord with debris, stay away from the debris area, and do not put the power cord in the water. We do not recommend the use of extension cord, as it may cause heat and fire, if you must use extension cord, please use at least 0.824 square mm or 18 thickness or above, rated voltage above 10A/110V power cord.



DANGER: The equipment must be grounded.

- Please pull the plug before cleaning or performing any repairs. Scrub the shell with a dry soft cloth. Prevent liquid from flowing into the machine.
- Be careful to control children when they approach the machine.
- Do not use the ice machine outdoors. Avoid sunlight. Make sure there is at least 15 centimeters of space between the device and the wall.
- No liquid other than drinking water should be used to make ice cubes.
- Do not clean the ice machine with flammable liquid, which can cause a fire or explosion.
- In order to avoid the risk of machine instability, it must be placed horizontally.
- If the ice machine is used in winter, it must be restored to room temperature before the power can be switched on for normal use.
- This device is not suitable for persons (including children) with poor physical condition, poor sensory or mental ability and lack of experience. They cannot operate unless they are supervised or directed by a guardian.
- Monitor children to make sure they do not play with the device.
- Please dispose of refrigerants and vesicant flammable gases in accordance with local regulations. To discard the ice machine, please take it to the recycle bin.
- The color of the wire is as follows:

Green&Yellow	Grounded wire
Blue&Brown	electrified

After the reception

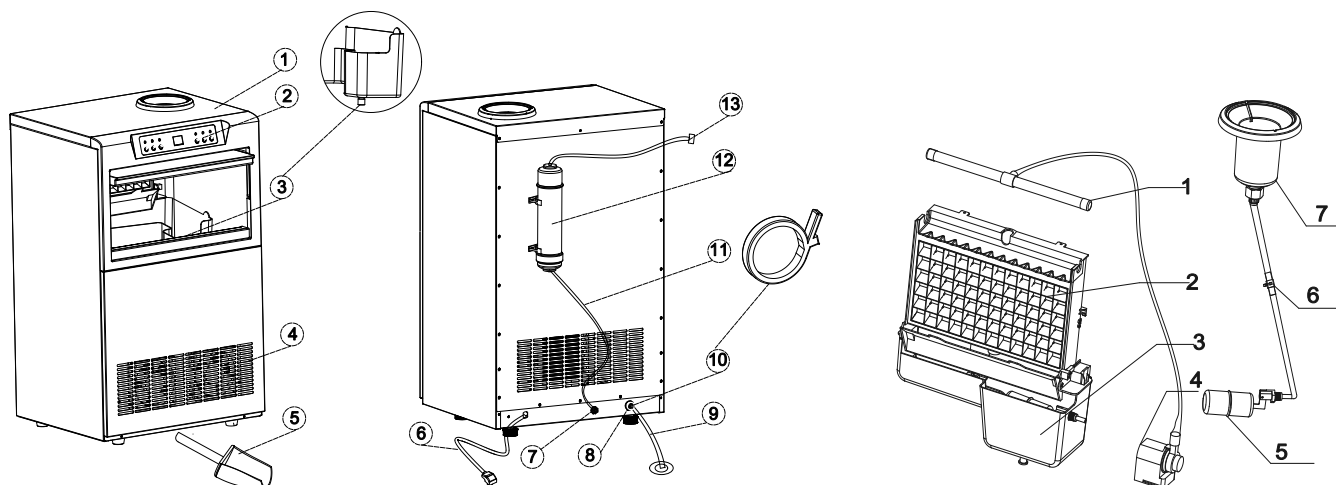

1. TOP COVER
2. CONTROL PANEL
3. SILICONE WATER PLUG
4. FAN
5. ICE SPOON

6. POWER CORD
7. WATER INLET
8. DRAIN OUTLET
9. DRAINPIPE
10. DRAIN PIPE FIXED TIE
11. PE INLET PIPE
12. FILTER
13. TAP WATER CONNECTOR

- 1 DISTRIBUTIVE PIPE
- 2 ICE PALLET
- 3 LEVEL CONTROLLER
- 4 PUMP
- 5 WATER BASIN PLUG
- 6 WATER VALVE
- 7 BOTTLE HOLDER

Open the box

Remove the inner and outer packing and check whether the drain pipe and ice scoop are inside the machine. If any do not, please contact our customer service.

Connect the power



WARNING: If you do not use this product for 24 hours, it is recommended that you take out the ice cubes from the ice storage tank and open the glue at the bottom of the drain to drain the water.



DANGER: * improper use of earthing plugs can lead to hazards. If the power cord is damaged, please call our service hotline.

For your safety, the equipment should be properly grounded. The power cord of the ice maker is plugged into the socket.

Do not cut the power cord. Many problems with the use of the power cord should follow the electrician's instructions.

Operation

How to operate

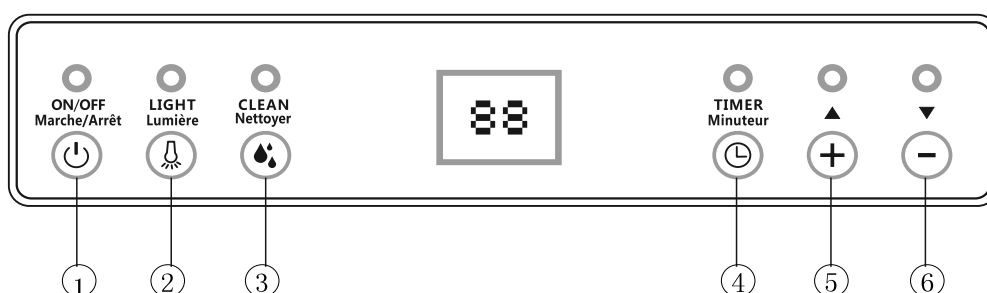

① ON/OFF button:

1. In standby mode, click the ON/OFF button to start the ice-making mode.
2. When the ice is running, click the ON/OFF button to stop the machine and enter the standby mode.

② LIGHT button:

1. Press the LIGHT button to turn the blue light on, and click the LIGHT button again to turn off the blue light.

③ CLEAN button:

1. In standby state (other states are invalid), when there is no shortage of water, click the CLEAN button to enter the cleaning mode. Click the CLEAN button again to turn off the cleaning mode. After the cleaning mode is started, there is no shutdown action within 10 minutes, and then it will automatically turn off after 10 minutes and automatically enter the standby state.
2. During the ice-making operation, press the CLEAN button for 3 seconds to enter the forced de-icing mode, and continue the ice-making operation after completing the de-icing mode.

④ TIMER button:

1. Click the TIMER button in the power-on state to enter the appointment shutdown settings.
2. Click the TIMER button in the standby state to enter the appointment boot settings.

⑤ + button:

1. Enter the TIMER appointment setting when on standby and press the + button to set the appointment boot time, press one time plus 1 hour (0 ~ 24h). After setting, the digital display tube will flash for 5 seconds to confirm.
2. Enter the TIMER reservation setting during the boot operation and press the + button to set the appointment shutdown time, and press one time plus 1 hour (0 ~ 24h). After setting, the digital display tube will flash for 5 seconds and then confirm.
3. Click the + button in standby mode and ice-making operation to increase the ice-making time (increase ice thickness), and the next round will take effect after setting.

⑥ - Button:

1. Enter the TIMER appointment setting when on standby and press the - button to set the appointment boot time, and press 1 hour (0 ~ 24h) at a time. After setting, the digital display tube will flash for 5 seconds to confirm.
2. Enter the TIMER appointment setting during the boot operation and press the - button to set the appointment shutdown time, and press 1 hour (0 ~ 24h) at a time. After setting, the digital display tube will flash for 5 seconds and then confirm.
3. Click the - button in standby mode and ice-making operation to increase the ice-making time (increase ice thickness), and the next round will take effect after the setting.

Operation guide

1. **LIGHT** : Press once to turn on the light, then press to turn off the light
2. **CLEAN** : Press once to clean the Ice tray , Long press to forced deicing
3. **ON/OFF**: Long press to turn on , the display will show "01, 02, 03, 04,... 60"(second) after that show "1, 2. 3...."(minute), then long press again to turn off.

4. **TIMER:** Press once timer button then press +/- to booking, 1 means 1hour, 2 means 2hours....Press this button when the machine running to schedule a shutdown time, press this button when the machine is turned off to schedule the boot time. When the operation is completed, click again TIMER button to confirm
5. **+/-:** Directly press the +/- button to adjust the thickness of the ice, adjust the range -6 ~ 0 ~ 6, the larger the value, the thicker the ice. Too thick and too thin ice is not conducive to deicing.

Installation guide

A : with bottled water

1. Put bottled water on the water guard.
2. Open the valve inside the machine

B : with pipe-line water

1. Install the filter on the back of the machine
2. Open the stopper, Insert the water pipe, Attach the blue buckle, Connect the faucet at the other end

Cleaning and maintenance

*Clean the ice maker thoroughly before using it.

*Ice machine is not used for a long time, to the bottom of the sink drain gum plug open the water off, and then use a soft cloth to clean the ice machine.

*We recommend that after a period of use (360 hours), the ice machine must be cleaned.

Clean the ice supply pipe and water guard regularly. The water in the tank must be replaced if it has not been used for more than 96 hours to keep the water clean. If the machine is not used for a long time, drain the water left in the sink. And remove the bucket or close the water supply valve.

- ① Remove the ice scoop. Soak the soft cloth with warm water diluted environmental protection detergent and wipe the machine and accessories clean.
- ② Rinse the ice scoop with room temperature drinking water, then connect the drain on the back of the machine to drain the water out.
- ③ The outside of the ice machine should be washed and wiped regularly with a soft cloth soaked with the liquid of environmental protection detergent diluted with room temperature water.
- ④ Finally, dry the inside and outside with a clean soft cloth.
- ⑤ When you hear that the compressor and water pump are working, but there is no water coming out from the ice supply pipe, please turn off the ice maker and remove the ice supply pipe for cleaning, so that each hole on the pipe wall is unobstructing, and at the same time clean the water filter net in the water tank with a brush. After cleaning, be sure to connect the end of the water supply pipe with the silicone tube firmly.

- ⑥ For the cleaning of the water tank and the inside of the machine, to use room temperature water diluted environmental protection detergent liquid soaked in a soft cloth to clean and wipe, with room temperature drinking water for many times to wash the water tank and inner barrel. Use the ice machine after all the water has been drained. This will keep the machine clean and clear, while also keeping it working properly.

Error

ERROR	Probable Cause	Solutions
The machine stops working, and the "▽" light (lack of water) flashes.	No enough water	Fill the bucket with water. Open the direct water supply valve.
Water guard ooze water	The direct water supply valve is not closed. Or a broken bucket	Close the water valve. Replace the bucket
The water tank is full, but the "▽" light (lack of water) is still flashing.	The float that controls the water level is stuck	Clean the ice from the floating ball.
There is no water coming out of the ice supply pipe	The hole wall of the ice supply pipe is blocked	Close the ice maker and remove the ice supply pipe for cleaning, so that each hole on the pipe wall unobstructed
The water in the tank is cold, but you can't make ice cubes	The inside of the machine is too dirty	Clean the machine
	The water is not clean enough	Use clean water
When the ice is removed, the ice comes out sideways or does not come off	The ice machine is uneven	Adjust the height of the four base angles of the machine to make it level
The ice making cycle is normal, but no ice comes out	Excessive ambient or water temperature	Please use the ice maker between 16°C and 32°C and make ice from drinking water or pure water with low temperature
	Refrigerant leakage	Please ask professional technicians to check
	Damage to cooling system	Please ask professional technicians to check

Technical parameters and circuits

MODEL	FCMIM0017
RATED VOLTAGE	110V,60Hz
PROTECTION	I
CLIMATE TYPE	N
RATED COOLING CURRENT	2.9A
POWER	260W
REFRIGERATION	R290
TYPE OF COOLING	AIR
FOAMING AGENT	CYCLOPENTANE

Warranty



Note: the gas discharged from the ice machine is easy gas, the disposal of these gas, should comply with the relevant regulations.

Warranty information:

*Warning: maintain ventilation. Keep the air clear outside and inside the machine.

*Warning: do not break the refrigerant pipe.

The warranty only covers damage caused by defects in the material or technology itself. For repairs within the warranty period, please come to the authorized service center and bring the original invoice.

Failure to guarantee:

- Wear and tear
- Incorrect use. For example: overload, use of non - standard accessories.
- Intentional injury.
- Damage caused by non-compliance with the user's manual. For example, an inappropriate point source is connected.
- Partial or complete removal of equipment.

Error Description

E1	Temperature probe open circuit
E2	Temperature probe short circuit
E4	Failed to de-ice 3 times in a row
E5	After turning on the machine, if 90 minutes (no water shortage, no ice full) has not detected the reed switch and magnet separation

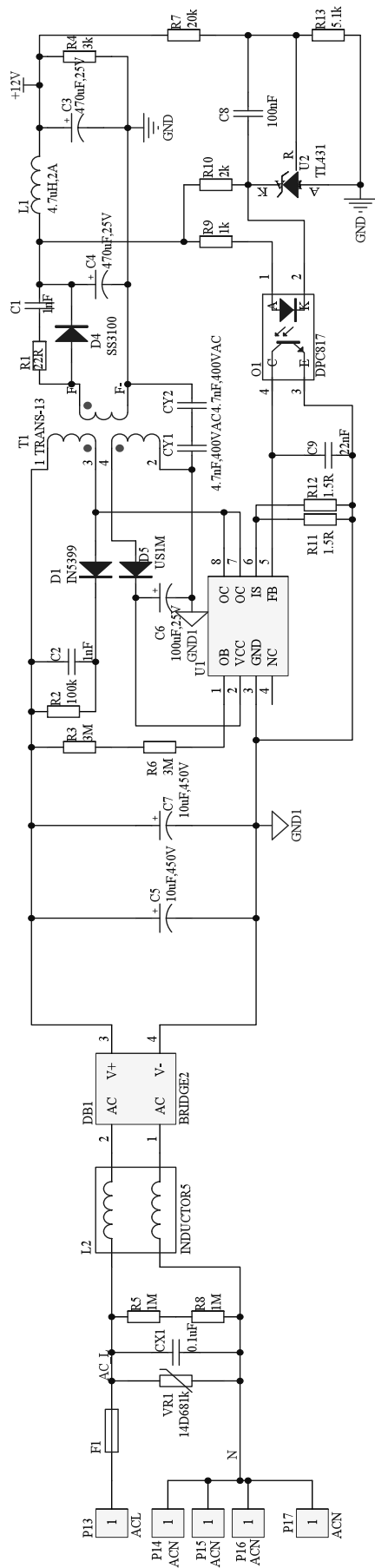



FOR
FAST SUPPORT
EMAIL AT **INFO@FORNO.CA** 

Customer Support: Call 1-866-231-8893 or email: info@forno.ca