

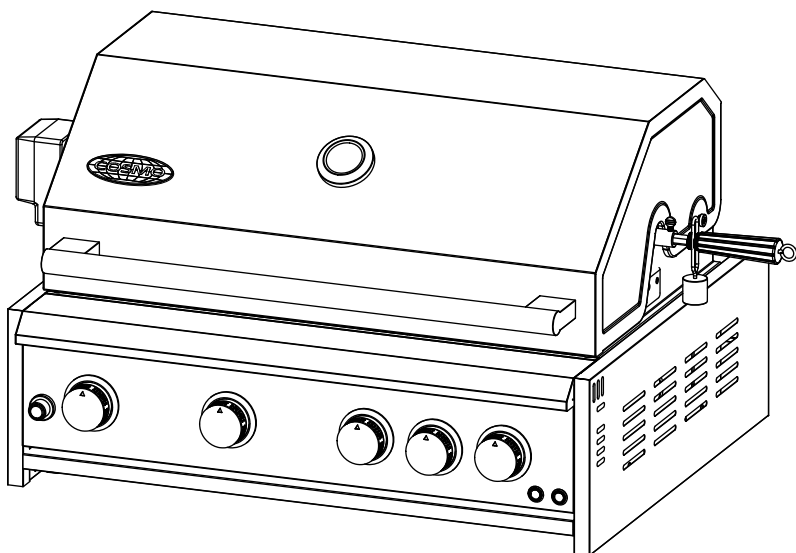

GAS GRILL

COS-BGGN325K



OUTDOOR BUILT-IN GRILL

GAS CONVERSION INSTRUCTIONS

IMPORTANT: READ AND SAVE THESE INSTRUCTIONS.
FOR RESIDENTIAL USE ONLY.

INSTALLER: PLEASE LEAVE THESE INSTRUCTIONS WITH THIS UNIT FOR
THE OWNER.

OWNER: PLEASE RETAIN THESE INSTRUCTIONS FOR FUTURE
REFERENCE.

THANK YOU FOR YOUR PURCHASE

Thank you for your purchase. We know that you have many brands and products to choose from and we are honored to know that you have decided to take one of our products into your home and hope that you enjoy it.

COSMO Appliances are designed according to the strictest safety and performance standard for the North American market. We follow the most advanced manufacturing philosophy. Each appliance leaves the factory after thorough quality inspection and testing. Our distributors and our service partners are ready to answer any questions you may have regarding how to install, use and care for your products. We hope that this manual will help you learn to use the product in the safest and most effective manner.

Before using this product, please read through this manual carefully. Keep this user manual in a safe place for future reference. Please ensure that other persons using this product are familiar with these instructions as well.

If you have any questions or concerns, please contact the dealer from whom you purchased the product, or contact our Customer Support at:

1-888-784-3108

Reach us online at:

www.cosmoappliances.com

TABLE OF CONTENTS

Gas Grill Safety	4
Gas Conversion	7
Tools and Parts	8
LP to NG Conversion	9
Removing Grill Components	9
Replacing Front Orifices	11
Replacing the Rear Orifice	13
Adjusting Burner Valves	14
Replacing the Gas Pipe	14
Testing and Final Checklist	15
Reassembling the Grill	16
NG to LP Conversion	16
Removing Grill Components	16
Replacing Front Orifices	18
Replacing the Rear Orifice	20
Adjusting Burner Valves	21
Replacing the Gas Pipe	21
Testing and Final Checklist	22
Reassembling the Grill	22
Warranty and Service	23

GAS GRILL SAFETY

READ ALL INSTRUCTIONS BEFORE USING THE APPLIANCE

Your safety and the safety of others are very important.

We have provided many important safety messages in this manual and on your appliance. Always read and obey all safety messages.



This is the safety alert symbol.

This symbol alerts you to potential hazards that can kill or hurt you and others.

All safety messages will follow the safety alert symbol and either the word "WARNING" or "CAUTION." These words mean:



You can be killed or seriously injured if you don't follow instructions.



A potentially hazardous situation which, if not avoided, could result in minor or moderate injury.

All safety messages will tell you what the potential hazard is, tell you how to reduce the chance of injury, and tell you what can happen if the instructions are not followed.

In the State of Massachusetts, the following installation instructions apply:

- Installations and repairs must be performed by a qualified or licensed contractor, plumber, or gasfitter qualified or licensed by the State of Massachusetts.
- If using a ball valve, it shall be a T-handle type.
- A flexible gas connector, when used, must not exceed 3 feet (91.5 cm).

California Proposition 65 Warning



Cancer and Reproductive Harm - www.P65Warnings.ca.gov.

WARNING

- Use outdoors only.
- Read the instructions before using the appliance.
- Warning: accessible parts may be very hot. Keep young children away.
- This appliance must be kept away from flammable materials during use.
- Do not move the appliance during use.
- Do not modify the appliance.
- Turn off the gas supply at the gas container after use.

WARNING

Never Operate the Top Surface Grill Section of this Appliance Unattended.

- Failure to follow this warning statement could result in fire, explosion, or burn hazard that could cause property damage, personal injury, or death.
- If a fire should occur, keep away from the appliance and immediately call your fire department.

DO NOT ATTEMPT TO EXTINGUISH AN OIL/GREASE FIRE WITH WATER.

WARNING

- Gas leaks cannot always be detected by smell. Gas suppliers recommend that you use a gas detector approved by UL or CSA. For more information, contact your gas supplier.
- Do not install a ventilation system that blows air downward toward this cooking appliance. This type of ventilation system may cause ignition and combustion problems with this cooking appliance resulting in personal injury or unintended operation.
- This appliance is intended for normal residential use. It is not approved for commercial use, or any other application not specifically allowed by this manual.
- This appliance requires connection to a 3-prong, 120VAC single-phase (split-phase), 60Hz grounded electrical source protected by a 15- or 20-Amp circuit breaker or slow blow fuse. When installed, appliance must be electrically grounded in accordance with local codes or, in the absence of local codes, with the National Electrical Code, NFPA 70 or the Canadian Electric Code, CSA C22.1-02.
- Proper installation is the responsibility of the installer. Any adjustment and service should be performed only by qualified gas grill installers or service technicians. The manufacturer is not responsible for any injury or damage that may result from incorrect or defective installation by unauthorized personnel.
- Product failure due to improper installation is not covered under warranty.

WARNING

- A child or adult can tip the gas grill and be killed.
- Ensure the grill is placed on a stable, level surface to prevent tipping during use.
- Lock wheels (if applicable) or place the grill in a secure position to avoid movement.
- Do not operate the grill on uneven or unstable surfaces.
- Failure to follow these instructions can result in injury or burns.

GAS CONVERSION

WARNING



FIRE AND EXPLOSION HAZARD

Failure to follow these instructions exactly could result in a fire, explosion, property damage, serious injury, or death.

- Never store or use gasoline or other flammable liquids or vapors near this grill or any other appliance.
- Do not store gas cylinders or containers not connected for use near this or any other appliance.

WHAT TO DO IF YOU SMELL GAS

- Turn off the gas supply to the grill immediately. Extinguish any open flames near the grill.
- Open the grill lid to allow gas to dissipate.
- If the gas odor persists, move away from the grill and call your gas supplier or the fire department right away.
- Ensure that all gas connections are tightly secured.
- A qualified technician should verify that the gas pressure does not exceed the recommended levels. Qualified personnel include:
 - Licensed heating specialists
 - Authorized gas company representatives
 - Certified service technicians

GAS CONVERSION REQUIREMENTS

Before you start: Ensure the gas supply is turned off and the grill is unplugged.

This grill is factory-set for use with Liquid Propane (LP). To convert to Natural Gas (NG), follow the steps below. The NG conversion kit is SOLD SEPARATELY.

To Purchase the NG/LP Conversion Kits Visit:

<https://cosmoappliances.com>



TOOLS AND PARTS INCLUDED IN THE KIT

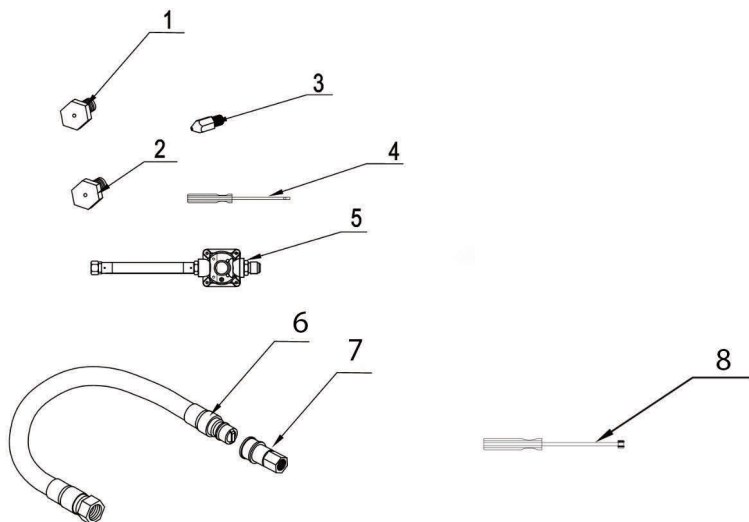

INCLUDED

- | | |
|--|-----------------------------|
| 1. Front Infrared Burner Orifice (Natural Gas) - 1 | 6. NG Gas Hose |
| 2. Main Tube Burner Orifice (Natural Gas) - 3 | 7. NG Quick Connect Fitting |
| 3. Rear Infrared Burner Orifice (Natural Gas) - 1 | 8. 6mm Hex Driver |
| 4. Flathead Screwdriver | |
| 5. Natural Gas Regulator with a Hose | |

NOT INCLUDED

- Wrench
- Phillips Head Screwdriver

IMPORTANT: Gas conversions must be done by a qualified service technician in accordance with the manufacturer's instructions and all codes and requirements of the authority having jurisdiction. The qualified agency performing this work assumes the gas conversion responsibility.

Keep and store the Liquid Propane (LP) gas hose that has just been replaced in case of re-installation with the Natural (NG).

NOTE:

- If converting to NG from LP please apply a label sticker with "NG Converted" notice on or near the regulator cover. If converting back to LP from NG, please remove the sticker so others know the appliance is set to use Liquid Propane.

LP TO NG CONVERSION STEPS

Removing Grill Components

1. Lift the grill hood and ensure the grill is turned off and cooled down.
2. Take out the Warming Rack, Rotisserie, Grates, Heat Plates. Set these aside carefully.

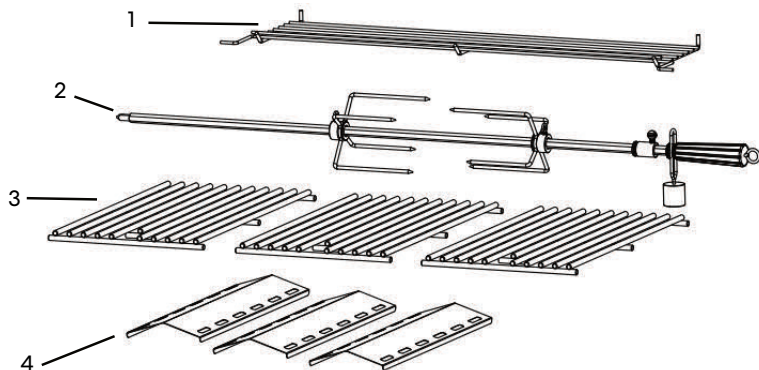

1. Warming Rack

3. Grates

2. Rotisserie

4. Heat Plates

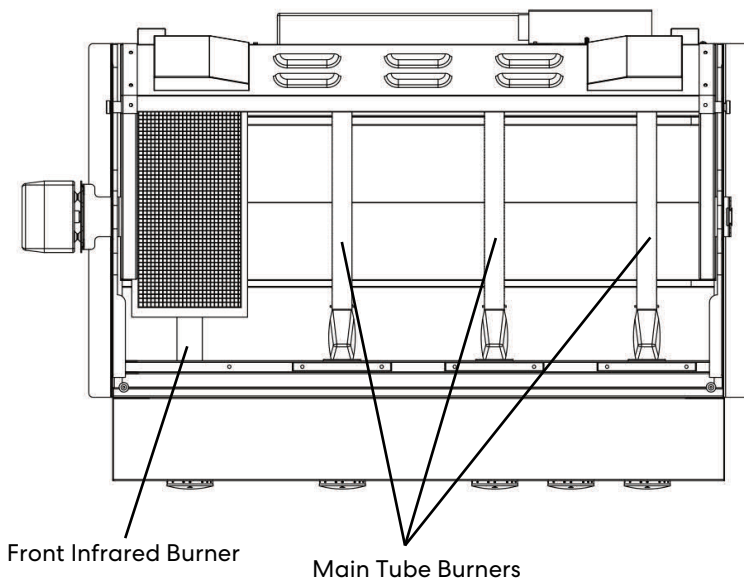

- 3.** Use a Phillips head screwdriver to remove the screws located near the front infrared burner and the main tube burners.

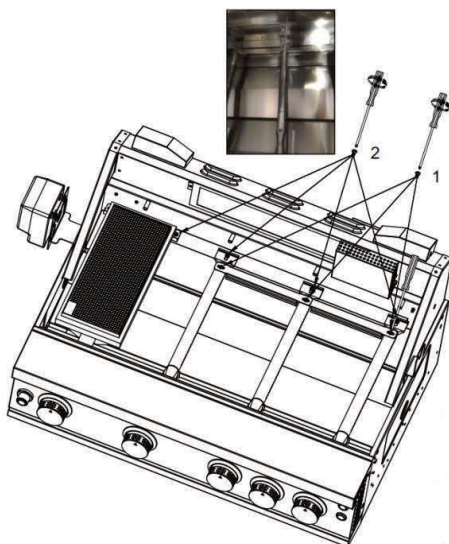

- 4.** Once the screws are removed, carefully lift out both the front infrared burner and the main tube burners.

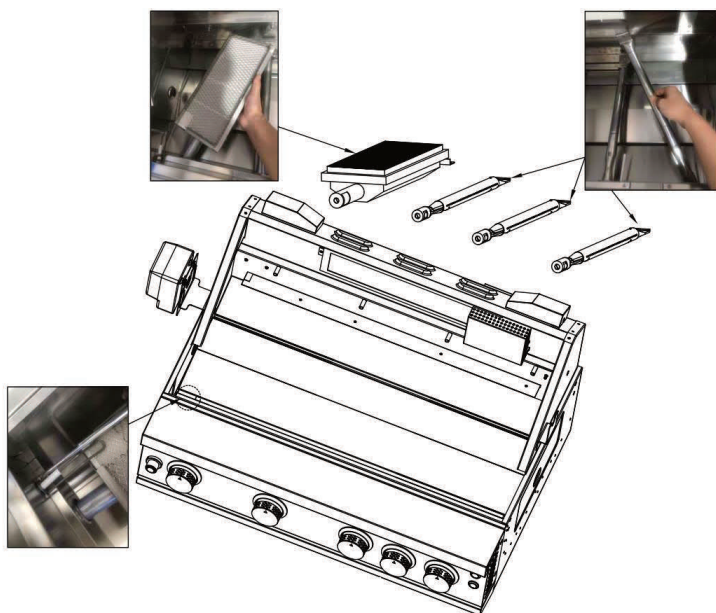

Replacing Front Orifices

The next step is to replace the Liquid Propane (LP) orifices with Natural Gas (NG) orifices.

Below diagram shows the size of the orifices and the burners replacement.

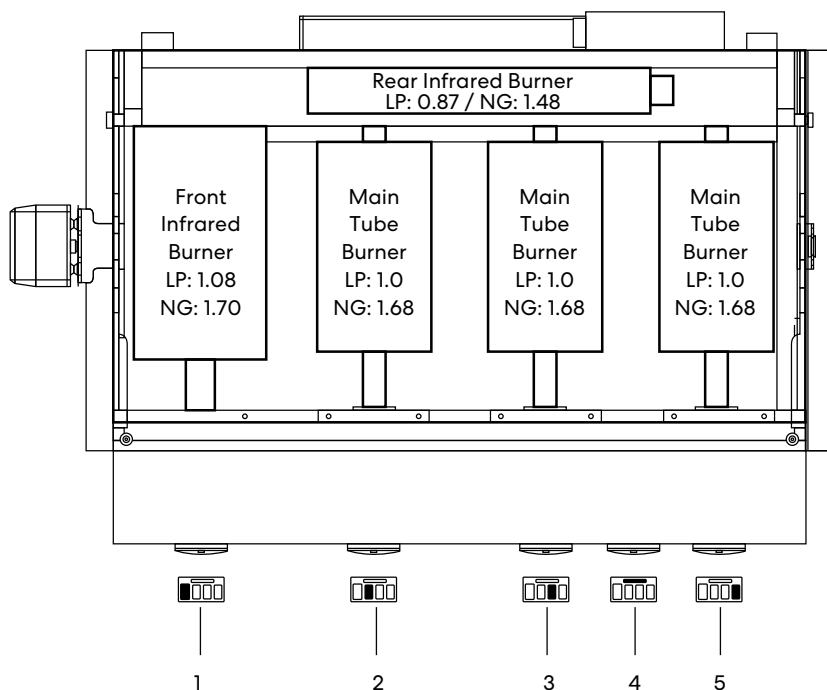

Check the layout of the five burner knobs. From left to right:

1. Front Infrared Burner Knob
2. Left Main Tube Burner Knob
3. Middle Main Tube Burner Knob
4. Rear Infrared Burner Knob
5. Right Main Tube Burner Knob

The orifices are located at the base of each burner tube. Use the 6mm hex driver (included in the NG conversion kit) to remove the pre-installed Liquid Propane (LP) orifices from the burner valve inside the grill cavity. Once removed, install the Natural Gas (NG) orifices. Refer to the detailed orifice information below for the correct sizes.

Burner	NG Orifice Size (mm)	LP Orifice Size (mm)	Quantity
Main Tube Burner	1.68	1.0	3
Infrared Burner (Front)	1.70	1.08	1

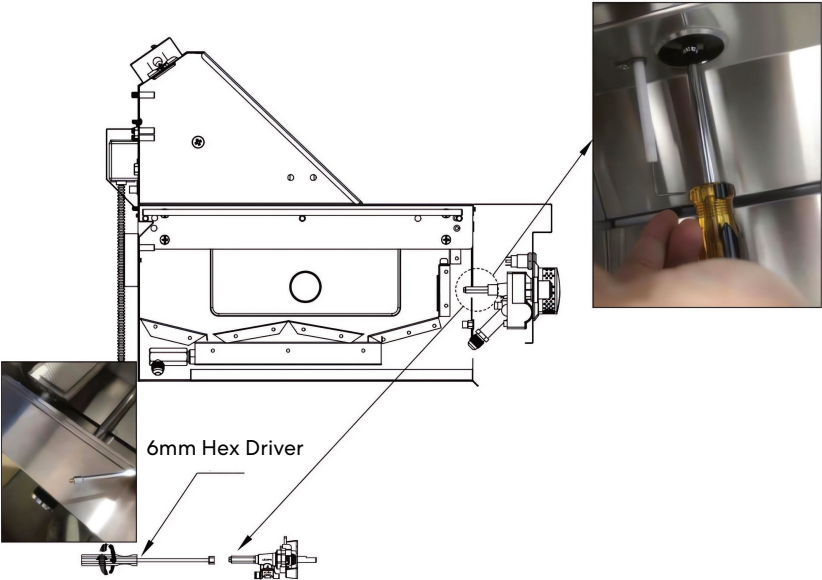

1. Turn counterclockwise to remove LP orifice.



2. Turn clockwise to put in NG orifice.

Replacing the Rear Orifice

- 1. Open the grill hood. Remove the four screws (circled in the image below) on the right of rear infrared burner from the front and detach the orifice access cover from the back of grill.
- 2. Use wrench to remove the existing LP Orifice (0.87mm) by turning counterclockwise direction so that it could be removed.
- 3. Use wrench to screw in NG orifice (1.48mm) by turning clockwise direction to install; Detailed orifice information is shown below:

Burner	NG Orifice Size (mm)	LP Orifice Size (mm)	Quantity
Infrared Burner (Rear)	1.48	0.87	1

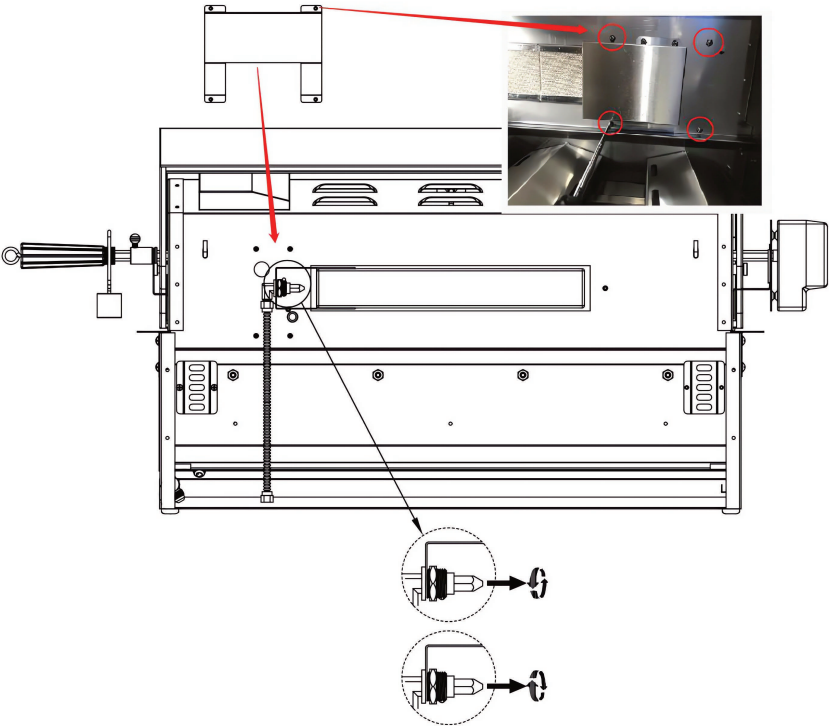

Adjusting Burner Valves

1. Remove all five burner knobs to access the burner valve for adjustments.

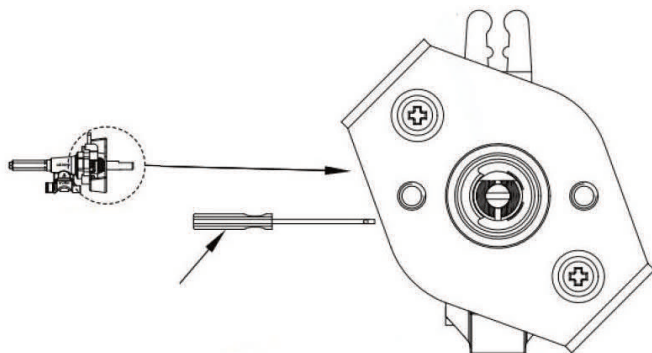

2. Use the Flathead Screwdriver (provided in the kit) to adjust the burner valve for the Natural Gas (NG). Turn the valve stem clockwise direction until it reaches the end to set it for NG.

Replacing the Gas Hose

1. Use wrench to take out the LP gas hose by turning it counterclockwise.

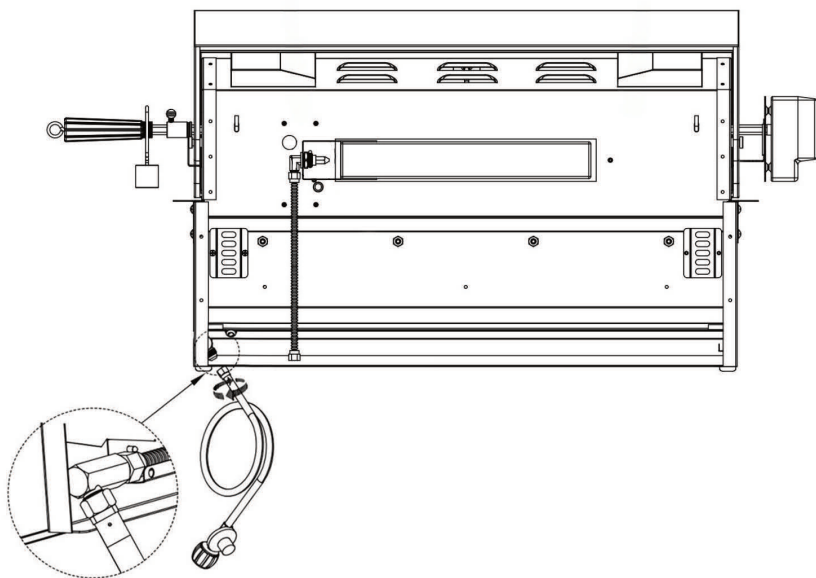

2. Follow the directions below to input NG Regulator with a Hose, NG Gas Hose, NG Quick Connect Fitting by turning it clockwise. Use the wrench to install the connection to the grill.

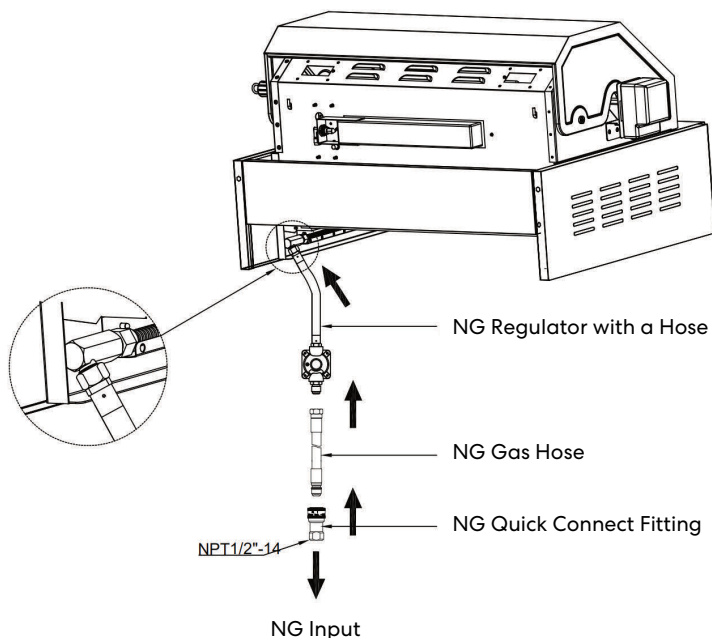

Testing and Final Checklist

Safety and Performance Check after NG Conversion:

Once the conversion is complete, follow these steps to test your grill and ensure safe operation.

1. Turn on the gas supply and apply a soapy water solution around the gas connections. If bubbles form, tighten the connections until no bubbles appear.
2. All the distance between tube needle and burner orifice should be around $7/64 - 3/16$ inch (3 – 5 mm)
3. Make sure that the regulator gas pressure is 4-inch (101.6 mm) water column for NG. Check the flame condition (See below picture)
 - Visually check the burner flames. They should be blue or slightly yellow.
 - Check and clean all burners for insects and insect nests. A clogged tube can lead to fire hazard under the outdoor cooking grill.

If the flame is incorrect, revisit the valve adjustments.



Reassembling the Grill

After completing the conversion, reassemble the grill.

Reinstall the Warming Rack, Grates, Heat Plates and Rotisserie: Place the warming rack, grates, heat plates and Rotisserie back into position and secure them.

Steps to Convert Back to Liquid Propane from NG to LP:

Removing Grill Components

1. Lift the grill hood and ensure the grill is turned off and cooled down.
2. Take out the Warming Rack, Rotisserie, Grates, Heat Plates. Set these aside carefully.

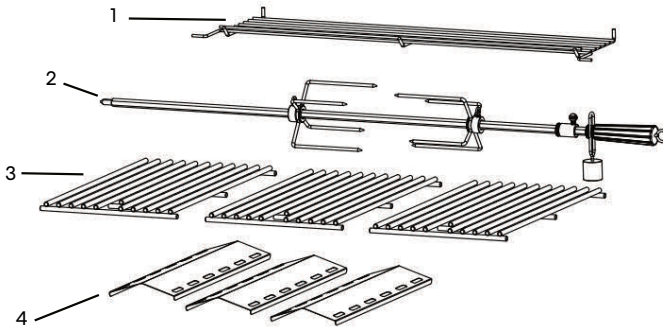

1. Warming Rack

3. Grates

2. Rotisserie

4. Heat Plates

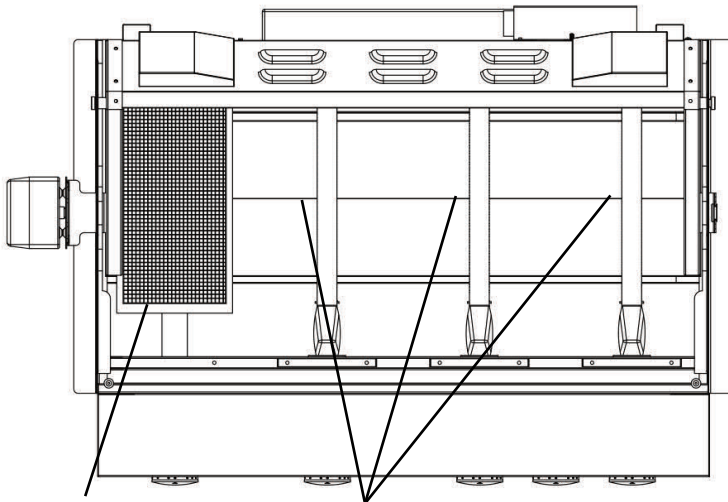

Front Infrared Burner

Main Tube Burners

3. Use a Phillips head screwdriver to remove the screws located near the front infrared burner and the main tube burners.

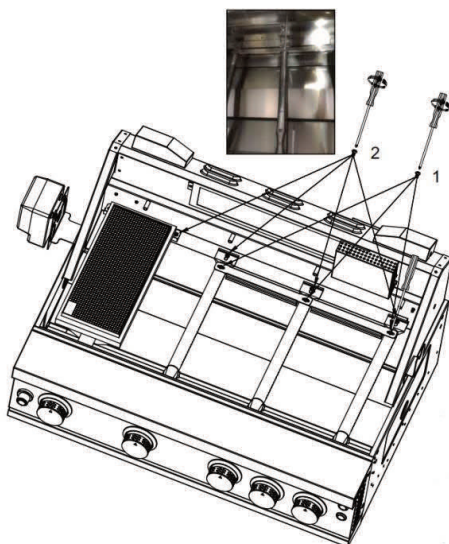

4. Once the screws are removed, carefully lift out both the front infrared burner and the main tube burners.

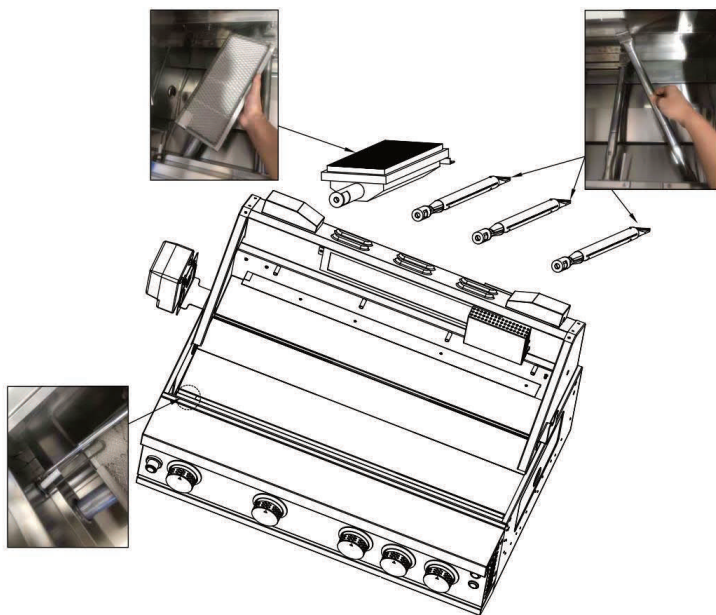

Replacing Front Orifices

The next step is to replace the Natural Gas (NG) orifices with Liquid Propane (LP) orifices.

Below diagram shows the size of the orifices and the burners replacement.

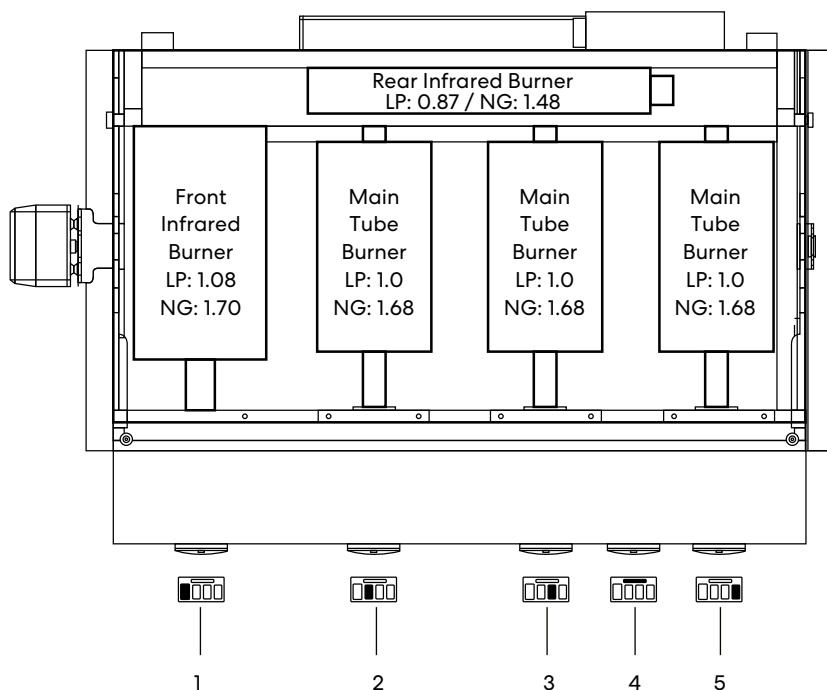

Check the layout of the five burner knobs. From left to right:

1. Front Infrared Burner Knob
2. Left Main Tube Burner Knob
3. Middle Main Tube Burner Knob
4. Rear Infrared Burner Knob
5. Right Main Tube Burner Knob

The orifices are located at the base of each burner tube. Use the 6mm hex driver (included in the LP conversion kit) to remove the pre-installed NP orifices from the burner valve inside the grill cavity. Once removed, install the LP orifices. Refer to the detailed orifice information below for the correct sizes.

Burner	NG Orifice Size (mm)	LP Orifice Size (mm)	Quantity
Tube Burner	1.68	1.0	3
Infrared Burner (Front)	1.70	1.08	1

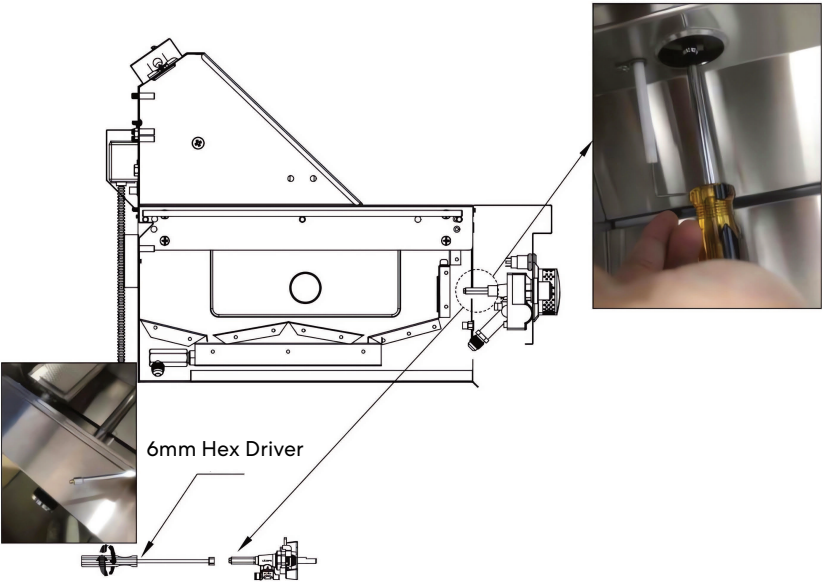

1. Turn counterclockwise to remove NG orifice.



2. Turn clockwise to put in LP orifice.

Replacing the Rear Orifice

1. Open the grill hood. Remove the four screws (circled in the image below) on the right of rear infrared burner from the front and detach the orifice access cover from the back of grill.
2. Use wrench to remove the existing NG Orifice (0.87mm) by turning counterclockwise direction so that it could be removed.
3. Use wrench to screw in LP orifice (1.48mm) by turning clockwise direction to install; Detailed orifice information is shown below:

Burner	NG Orifice Size (mm)	LP Orifice Size (mm)	Quantity
Infrared Burner (Rear)	1.48	0.87	1

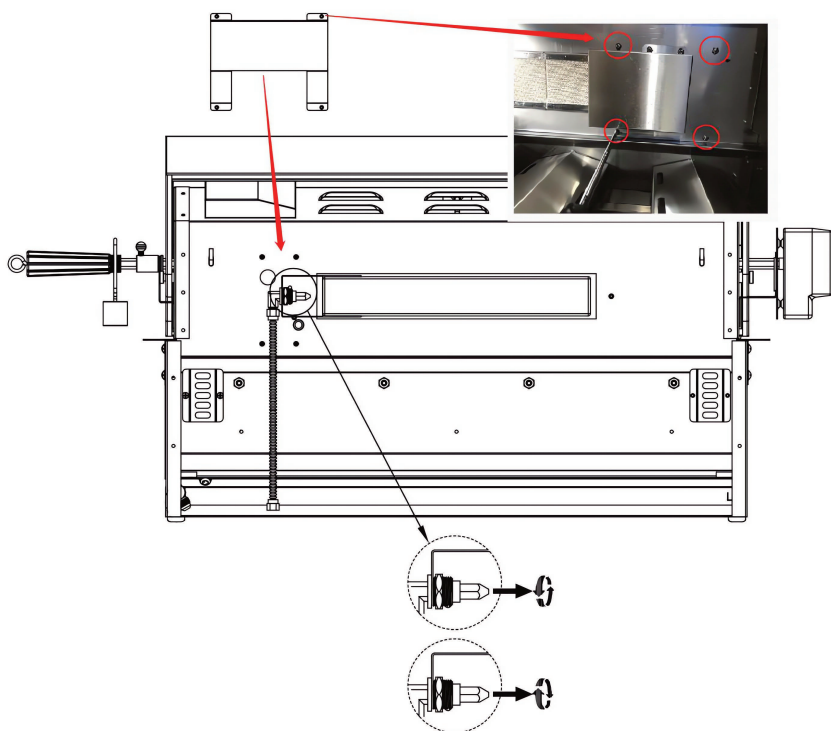

Adjusting Burner Valves

1. Remove all five burner knobs to access the burner valve for adjustments.

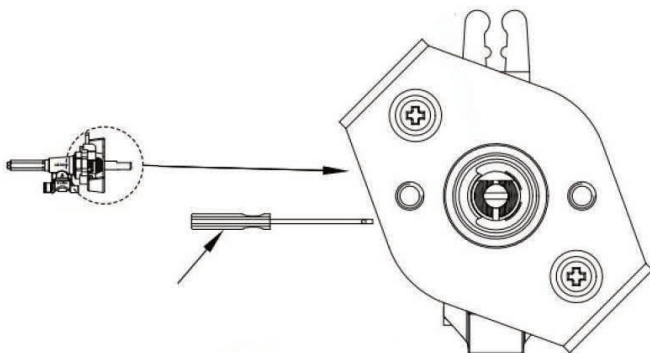

2. Use the Flathead Screwdriver (provided in the kit) to adjust the burner valve for the Liquid Propane (LP). Turn the valve stem clockwise direction until it reaches the end to set it for LP.

Replacing the Gas Hose

1. Use wrench to take out the NP gas hose by turning it counterclockwise.

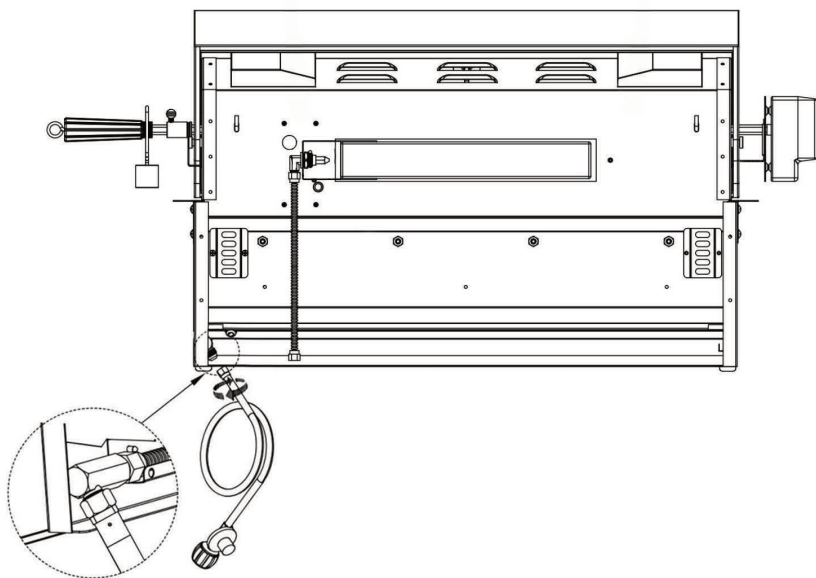

2. Follow the directions below to input NG Regulator with a Hose, NG Gas Hose, NG Quick Connect Fitting Coupling by turning it clockwise. Use the wrench to install the connection to the grill.

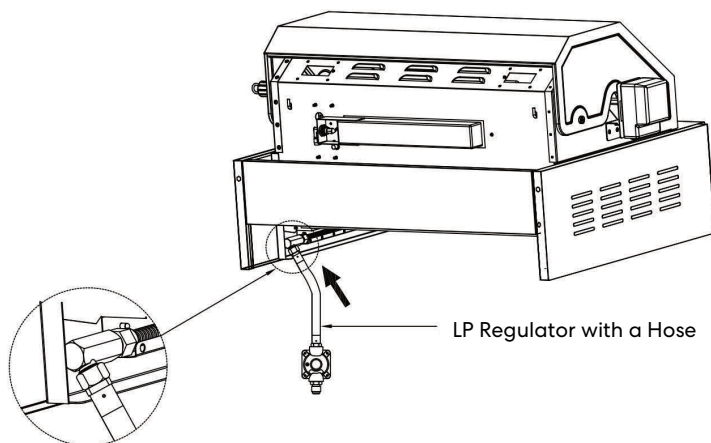

Testing and Final Checklist

Safety and Performance Check after Liquid Propane (LP) Conversion:

Once the conversion is complete, follow these steps to test your grill and ensure safe operation.

1. Turn on the gas supply and apply a soapy water solution around the gas connections. If bubbles form, tighten the connections until no bubbles appear.
2. All the distance between tube needle and burner orifice should be around $7/64 - 3/16$ inch (3 – 5 mm)
3. Make sure that the regulator gas pressure is 4-inch (101.6 mm) water column for LP. Check the flame condition (See below picture)
 - Visually check the burner flames. They should be blue or slightly yellow.
 - Check and clean all burners for insects and insect nests. A clogged tube can lead to fire hazard under the outdoor cooking grill.

If the flame is incorrect, revisit the valve adjustments.



Reassembling the Grill

After completing the conversion, reassemble the grill.

Reinstall the Warming Rack, Grates, Heat Plates and Rotisserie: Place the warming rack, grates, heat plates and Rotisserie back into position and secure them.

LIMITED WARRANTY

WARRANTY AND SERVICE

TO RECEIVE WARRANTY SERVICE, YOUR PRODUCT MUST BE REGISTERED.

TO REGISTER AND REVIEW FULL WARRANTY DETAILS, VISIT:

WWW.COSMOAPPLIANCES.COM/WARRANTY

SCAN TO REGISTER



CUSTOMER SUPPORT

TO CHAT WITH US LIVE FOR ASSISTANCE, VISIT:

WWW.COSMOAPPLIANCES.COM/CHAT

SCAN TO CHAT



IMPORTANT

Do Not Return This Product To The Store

If you have a problem with this product, please contact COSMO Customer Support at

+1 (888) 784-3108

DATED PROOF OF PURCHASE, MODEL #, AND SERIAL # REQUIRED FOR WARRANTY SERVICE.

IMPORTANT

Ne pas Réexpédier ce Produit au Magasin

Pour tout problème concernant ce produit, veuillez contacter le service des consommateurs Cosmo Customer Support au

+1 (888) 784-3108

UNE PREUVE D'ACHAT DATEE EST REQUISE POUR BENEFICIER DE LA GARANTIE.

IMPORTANTE

No regrese este producto a la tienda

Si tiene algún problema con este producto, por favor contacte el ayuda al cliente COSMO al

+1 (888) 784-3108

(Válido solo en E.U.A.)

NECESITA UNA PRUEBA DE DE COMPRA FECHADA, NÚMERO DE MODELO Y DE SERIE PARA EL SERVICIO DE LA GARANTÍA.



Correct disposal of this product:

This marking indicates that this appliance should not be disposed with other household wastes. To prevent possible harm to the environment or human health from uncontrolled waste disposal, recycle it responsibly to promote the sustainable reuse of material resources.

MEMO

Handwriting practice lines consisting of 15 horizontal dashed lines.

MEMO

MEMO



APPLIANCES

Cosmo is constantly making efforts to improve the quality and performance of our products, so we may make changes to our appliances without updating this manual.

Electronic version of this manual is available at:
www.cosmoappliances.com